

Machined End Caps

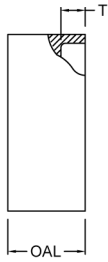

IPS Machined End Caps

- Pressure Rated for SDR Listed

Size [inch]	Part No.	T (min) [inch]	OAL [inch]	SDR11		SDR13.5	
				WPR [psi]	Weight [lbs]	WPR [psi]	Weight [lbs]
10		2.62	4.00	200	15	160	15
12		3.00	4.00	200	17	160	17
14		3.00	4.00	200	19	160	19
16 - (SDR11)		3.38	5.00	200	32		
16		2.87	4.00			160	24
18 - (SDR11)		3.80	5.00	200	41		
18		3.22	4.00			160	30
20 - (SDR11/17)		4.20	5.00	200	50		
20		3.00	4.00			160	50
22 - (SDR11)		4.65	6.00	200	75		
22		3.70	5.00			160	45
24 - (SDR11)		5.06	6.00	200	89		
24		4.00	5.00			160	68

Size [inch]	SDR 17		SDR 19		SDR 21		SDR 26		SDR 32.5	
	WPR [psi]	Weight [lbs]	WPR [psi]	Weight [lbs]	WPR [psi]	Weight [lbs]	WPR [psi]	Weight [lbs]	WPR [psi]	Weight [lbs]
10	130	15	110	15	100	15	80	15	65	15
12	130	17	110	17	100	17	80	17	65	17
14	130	19	110	19	100	19	80	19	65	19
16	130	24	110	24	100	24	80	24	65	24
18	130	30	110	30	100	30	80	30	65	30
20 - (SDR11/17)	130	50								
20			110	37	100	37	80	37	65	37
22	130	45	110	45	100	45	80	45	65	45
24	130	68	110	68	100	68	80	68	65	68

IPS Machined End Caps (10psi max.)

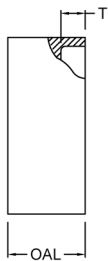

Size [inch]	Part No.	T (min) [inch]	OAL [inch]	Low Pressure	
				WPR [psi]	Weight [lbs]
26		3.00	4.00	10 max.	62
28		3.00	4.00	10 max.	72
30		3.00	4.00	10 max.	83
32		3.00	4.00	10 max.	94
34		3.00	4.00	10 max.	106
36		3.00	4.00	10 max.	115
40		3.00	4.00	10 max.	142
42		3.00	4.00	10 max.	157
48		3.00	4.00	10 max.	205
54		3.00	4.00	10 max.	253

DIPS Machined End Caps

- Pressure Rated for SDR Listed

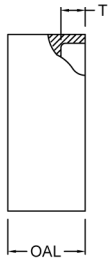

Size [inch]	Part No.	T (min) [inch]	OAL [inch]	SDR11		SDR13.5	
				WPR [psi]	Weight [lbs]	WPR [psi]	Weight [lbs]
4		1.00	3.00	200	2	160	2
6		1.50	3.00	200	4	160	4
8		2.00	3.00	200	6	160	6
10		2.40	4.00	200	12	160	12
12		2.80	4.00	200	18	160	18
14		3.30	5.00	200	30	160	30
16		3.68	5.00	200	38	160	38
18		4.12	5.00	200	48	160	48
20 - (SDR11-13.5)		4.60	6.00	200	98	160	98
20		3.70	5.00				
24 - (SDR11-13.5)		5.07	6.00	200	114	160	114
24		4.38	5.00				

Size [inch]	SDR 17		SDR 19		SDR 21		SDR 26		SDR 32.5	
	WPR [psi]	Weight [lbs]	WPR [psi]	Weight [lbs]	WPR [psi]	Weight [lbs]	WPR [psi]	Weight [lbs]	WPR [psi]	Weight [lbs]
4	130	2	110	2	100	2	80	2	65	2
6	130	4	110	4	100	4	80	4	65	4
8	130	6	110	6	100	6	80	6	65	6
10	130	12	110	12	100	12	80	12	65	12
12	130	18	110	18	100	18	80	18	65	18
14	130	30	110	30	100	30	80	30	65	30
16	130	38	110	38	100	38	80	38	65	38
18	130	48	110	48	100	48	80	48	65	48
20	130	70	110	70	100	70	80	70	65	70
24	130	94	110	94	100	94	80	94	65	94