

Fabricated Crosses

IPS Line Cross

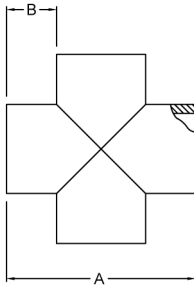

Size [inch]	Part No.	A [inch]	B [inch]	SDR 7		SDR9		
				WPR [psi]	Weight [lbs]	WPR [psi]	Weight [lbs]	
2		9.0	3.3					
3		10.3	3.4					
4		16.5	6.0	130	10	100	8	
6		18.6	6.0	130	22	100	18	
8		24.6	8.0	130	50	100	41	
10		26.8	8.0	130	83	100	67	
12		28.8	8.0	130	123	100	99	
14		32.0	9.0	130	165	100	132	
16		34.0	9.0	130	236	100	1192	
18		38.0	10.0	130	328	100	267	
20		40.0	10.0	130	423	100	342	
22		46.0	12.0	130	586	100	474	
24		48.0	12.0	130	1079	100	584	
26		54.0	14.0			100	792	
28		56.0	14.0			100	944	
30		58.0	14.0					
32		60.0	14.0					
34		74.0	20.0					
36		76.0	20.0					
42		82.0	20.0					
48		88.0	20.0					
54		94.0	20.0					

Size [inch]	SDR 11		SDR 17		SDR 21		SDR 26		SDR 32.5	
	WPR [psi]	Weight [lbs]	WPR [psi]	Weight [lbs]	WPR [psi]	Weight [lbs]	WPR [psi]	Weight [lbs]	WPR [psi]	Weight [lbs]
2	80	2								
3	80	3								
4	80	7								
6	80	16								
8	80	34								
10	80	55	50	38						
12	80	84	50	56						
14	80	109	50	74						
16	80	159	50	107						
18	80	224	50	152						
20	80	284	50	192						
22	80	397	50	267						
24	80	487	50	329						
26	80	663	50	449						
28	80	791	50	525						
30	80	934	50	631						
32	80	1092	50	733						
34	80	1670	50	1123						
36	80	1920	50	1292						
42			50	1856	40	1514				
48					40	1967	30	1602		
54							30	2273	25	1827

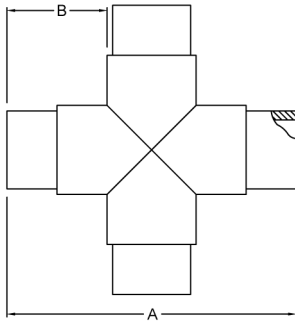

IPS Line Cross

- Reinforced
- Fully Pressure Rated With Full Flow ID

Size [inch]	Part No.	Feedstock OD [inch]	A [inch]	B [inch]	SDR 9 WPR [psi]	SDR 11 WPR [psi]	SDR 17 WPR [psi]
4		6.625	15.3	12.0	200	160	100
6		8.625	18.3	14.0	200	160	100
8		10.750	19.9	14.5	200	160	100
10		12.750	20.9	14.5	200	160	100
12		14.000	24.0	17.0	200	160	100
14		16.000	25.0	17.0	200	160	100
16		18.000	27.0	18.0	200	160	100
18		20.000	28.0	18.0	200	160	100
20		22.000	31.0	20.0	200	160	100
22		24.000	32.0	20.0	200	160	100
24		26.000	35.0	20.0	200	160	100

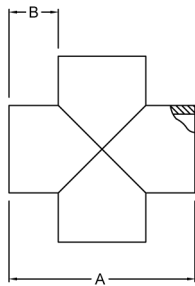

DIPS Fabricated Line Cross

Size [inch]	Part No.	A [inch]	B [inch]	SDR 7 WPR [psi]	Weight [lbs]	SDR9 WPR [psi]	Weight [lbs]
4		16.8	6.0	160	11	128	8
6		18.9	6.0	160	20	128	17
8		25.0	8.0	160	44	128	40
10		27.1	8.0	160	73	128	60
12		29.2	8.0	160	108	128	91
14		33.3	9.0	160	173	128	143
16		35.4	9.0	160	235	128	200
18		39.5	10.0	160	328	128	271
20		41.6	10.0	160	411	128	346
24		49.8	12.0	160	701	128	591
30		60.0	14.0	160	1288	128	1098

Size [inch]	SDR 11 WPR [psi]	Weight [lbs]
4		
6		
8		
10	80	43
12	80	62
14	80	97
16	80	132
18	80	183
20	80	234
24	80	398
30	80	737